

# MSSTAC5-2V

## RS232/485 Step drive

## Quick Set-Up Guide

### Requirements

You will need these items to set-up the MSSTAC5-2V:

- 94-265V AC power supply
- a small flat blade screwdriver for tightening the connectors (included)
- a PC running Microsoft Windows XP, Vista, or Windows 7
- a programming cable (included with RS-232 Models; 485 converters available from MOONS')

### Install the Software

- Download and install the ST Configurator Software from the MOONS' website.
- Launch the software by clicking Start... Programs ... MOONS'
- Connect the drive to the PC using the programming cable

### Connect the Power Supply

- Using the connector supplied to connect the AC power supply per the diagram below. For Line (L) and Neutral (N), use 16AWG wire. For Earth Ground (⊕), use 14AWG wire.
- Care should always be taken when working with high voltages.
- In regions where the single-phase supply is higher, an auto transformer can be used to drop the voltage to the correct level.

### Configure the Drive

- Apply power to the drive
- The software will recognize the drive & display the model & firmware version
- Follow the steps on the ST Configurator screens to set up the Motor and Motion & I/O

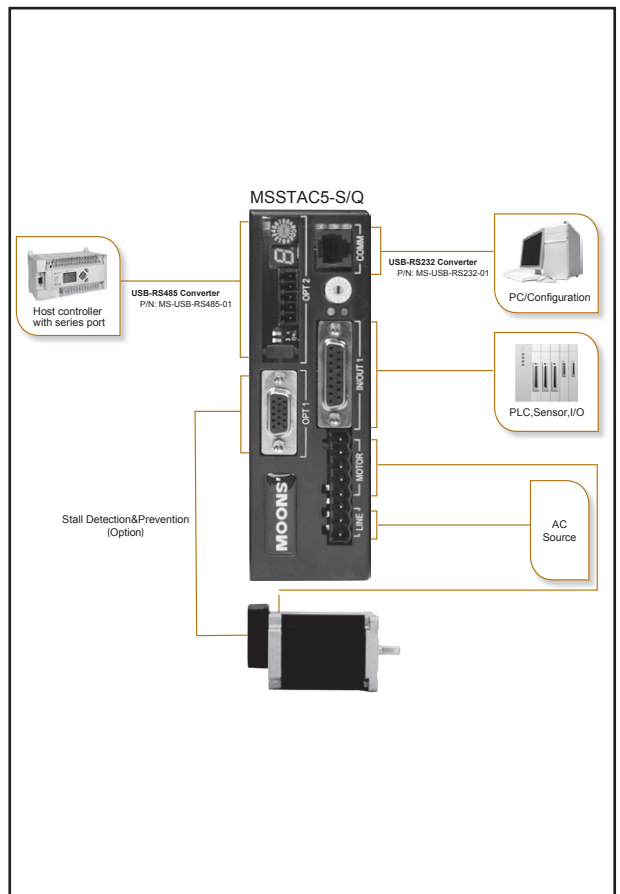

### Safety Instructions



- Only qualified personnel should assemble, install, operate, or maintain this equipment.
- Read all available documentation before assembly and operation.
- It is vital to ensure that all system components are connected to earth ground.
- This product contains electrostatically sensitive components that can be damaged by incorrect handling.

## Line Filter

For applications requiring CE EMC compliance, a line filter is required in series with the AC input. Here are two choices.

1. Vendor: Tyco Electronics Corcom Part Number: 6ET1
2. Vendor: LCR Electronics, inc. Part Number: 092.00721.00

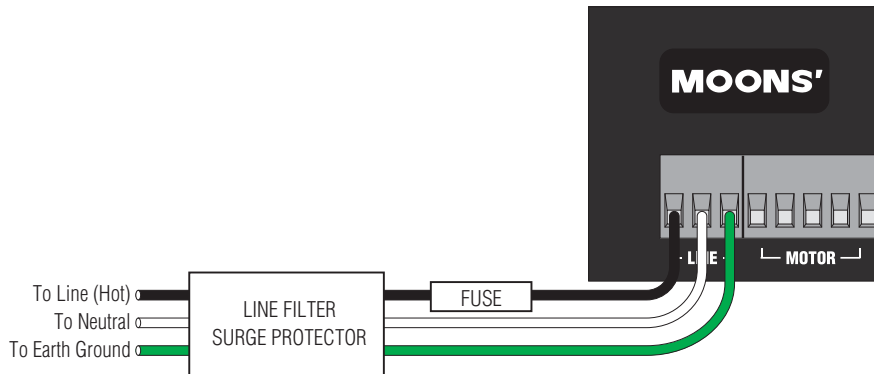

The connectors and other points of interest are illustrated below. Depending on your drive model and application, you'll need to make connections to various parts of the drive. These are detailed later in the manual.

