

Łańcuchy

Łańcuchy tulejowe wg europejskiej normy

DIN 8187 - ISO / R 606

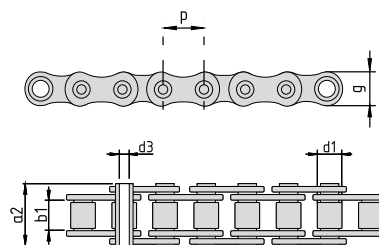
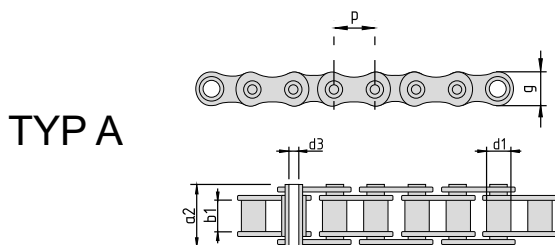

kod	ISO	podziątka P		b1 mm min	d2 mm	d1 mm max	a2 mm max	g mm max	F _B min N	q [kg/m] ≈	typ
		mm	cale								
D0100	08B-1	12,70	1/2"	7,75	4,50	8,51	17,00	11,60	9.400	0,59	A
D0101	10B-1	15,875	5/8"	9,65	5,18	10,16	19,60	14,70	12.800	0,73	A
D0103	12B-1	19,05	3/4"	11,68	5,85	12,07	22,70	15,90	12.800	1,10	A
D0104	08B-1	12,70	1/2"	7,75	4,50	8,51	17,00	11,60	10.800	0,59	B
D0105	10B-1	15,875	5/8"	9,65	5,18	10,16	19,60	14,50	14.700	0,77	B
D0106	12B-1	19,05	3/4"	11,68	5,85	12,07	22,70	15,90	16.700	1,02	B
D0107	16B-1	25,40	1"	17,02	8,33	15,88	36,10	20,50	32.800	2,25	B

Łańcuchy tulejowe nierdzewne wg europejskiej normy

DIN 8187 - ISO / R 606

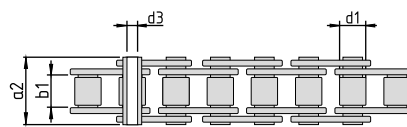
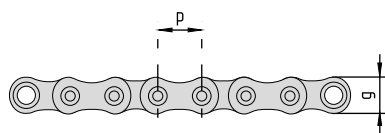

kod	ISO	podziątka P		b1 mm min	d2 mm	d1 mm max	a2 mm max	g mm max	F _B min N	q [kg/m] ≈
		mm	cale							
D0111	08B-1	12,70	1/2"	7,75	4,50	8,51	17,00	11,60	8.000	0,59
D0112	10B-1	15,875	5/8"	9,65	5,18	10,16	19,60	14,50	12.000	0,77
D0113	12B-1	19,05	3/4"	11,68	5,85	12,07	22,70	15,90	12.000	1,02
D0114	16B-1	25,40	1"	17,02	8,33	15,88	36,10	20,50	20.000	2,25